

## Mounting rails Symmetrical - DIN 3

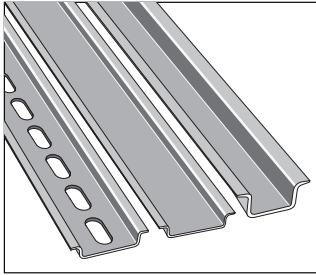

These rails are often used as grounding bars. The current carrying capacity of these rails and the copper wire sizes required to carry that current are given below.

### RAIL CURRENT CARRYING CAPACITY

Rail	Material	Current (A)	Wire size AWG	mm <sup>2</sup>
TS 35/F6	Steel	65	8	10
TS 35	Steel	87	6	16
TS 35/S	Steel	87	6	16
TS 35	Aluminum	265	000	95
TS 35	Copper	150	0	50
TS 35	Plastic	0		

All rails are in compliance with EN 50022 standard (DIN 46277-3 - NFC 63015) DIN 3.

Tolerances are ± unless otherwise noted.

### TS 35/F6

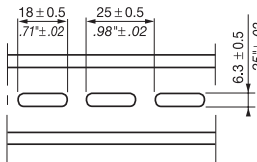
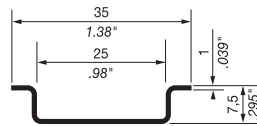
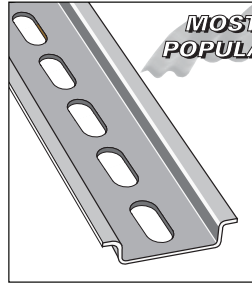

Type P/N  
PR30 (TS 35/F6) 0173 220.05

White passivated galvanized steel, prepunched length 2 m 6'6" (78") approx. The length and prepunched cut out dimensions are approximate.

PR30 (TS 35/F6) 0101 508.04  
Length 1 m 3'3" (39") approx.

### TS 35

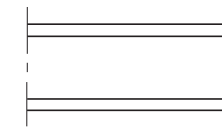
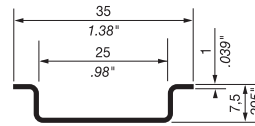
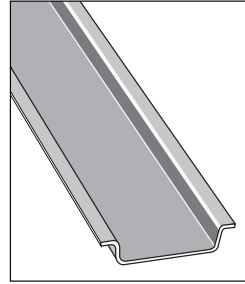

Type P/N  
PR3.Z2 (TS 35) 0174 300.17

White passivated galvanized steel. Length 2 m 6'6" (78") approx.

PR3.Z2 (TS 35) 0101 513.10  
Length 1 m 3'3" (39") approx.

### TS 35/S

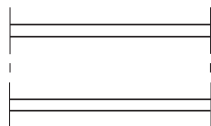
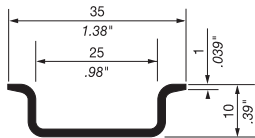
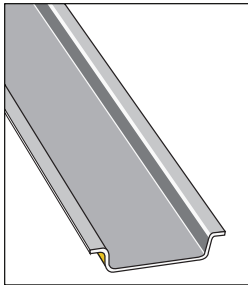

Type P/N  
PR3.10 (TS 35/S) 0101 597.15

White passivated galvanized steel. Height 10 mm (0.39"), length 2 m 6'6" (78") approx.

PR3.10 (TS 35/S) 0101 512.17  
Length 1 m 3'3" (39") approx.

### TS 35 Aluminum Rail

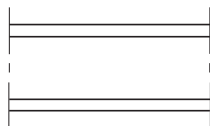
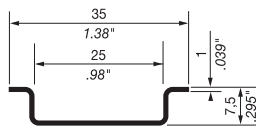
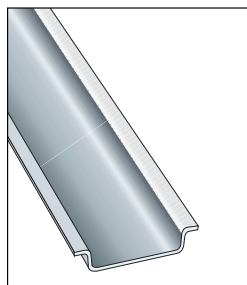

Type P/N  
PR3.AL (TS 35) 0101 500.24

Aluminum rail.

PR3.AL (TS 35) 0101 500.24  
Length 1 m 3'3" (39") approx.

### TS 35 Copper Rail

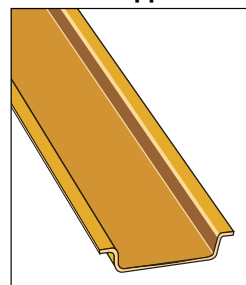

Sold in North America only.

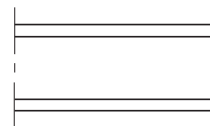
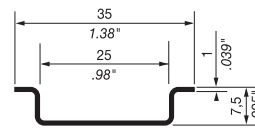

Type P/N  
PR3.CU (TS 35) 0101 592.10

Copper rail. Length 2 m 6'6" (78") approx.

PR3.CU (TS 35) 0101 595.13  
Length 1 m 3'3" (39") approx.